

DH-65 Series

Electromagnetic Door Holder Installation and Operation manual

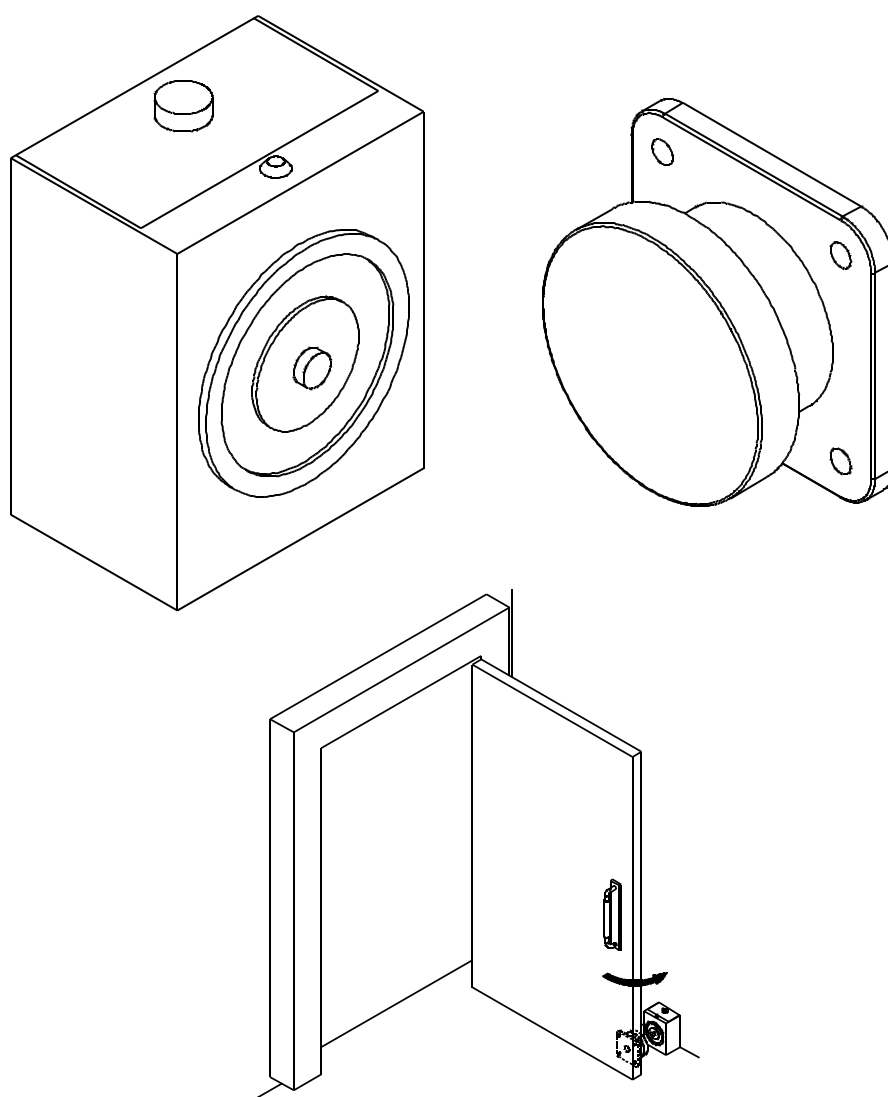

VER 12.08.15

※ Features

- 1.The armature is able to sway slightly in order to achieve maximum holding force when both armature and electromagnetic door holder are attached firmly in place.
- 2.Suitable for security door and all types of 90 door.
- 3.Built-in computer control board with door open delay function(DH-65T).
- 4.Built-in demagnetizer design. Instant demagnetization when power is off.
- 5.Power saving function with fail safe design .No power consumption when both armature and electromagnetic door holder do not attach with each other .
- 6.Built-in immediate power off push button. Press the button to demagnetize the door holder to release the door immediately when both door holder and armature are attached.

※ Dimensions

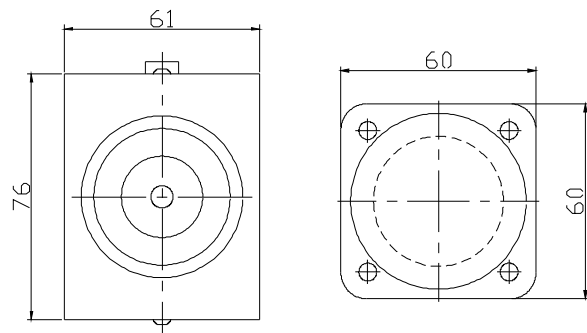

Front view

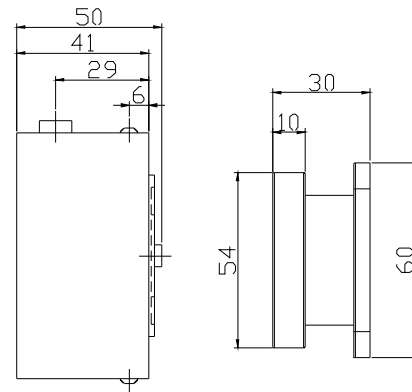

Side view

Unit:mm

※ Specifications

Product Specifications	DH-65	DH-65T
Power supply	Adjustable 12VDC/24VDC(12 VDC as default)	
Current	96mA@12V , 49mA@24V	113mA@12V , 71mA@24V
Signal Outputs	N.O. and N.C.output connectors	Not available
Door Close Delay Time	Not available	Adjustable 5mins to 10mins
Suitable for	Security door and all types of 90°door	
Holding force	65kg± 5kg(approximately 145 LBS)	
Operation temperature	-20℃ ~ 70℃	
Warranty	One year under normal circumstances	
Weight	700g	
Power saving function	Available	Available
Mounting methods	Wall mounting	
Immediate Power Off push button	Available	

※ Parts

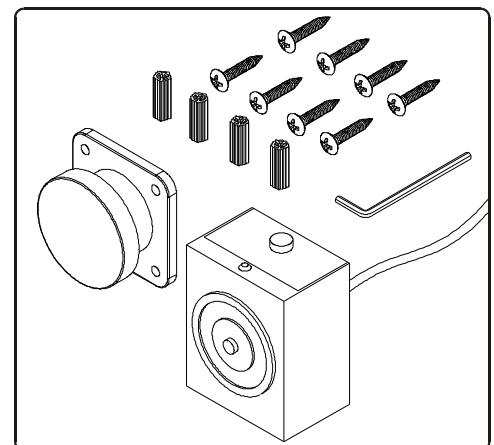

Accessories:

Specifications	Amount
Screw 5*25	8
Plastic plug	4
Hex Wrench	1

※ Control board

Disassemble the case

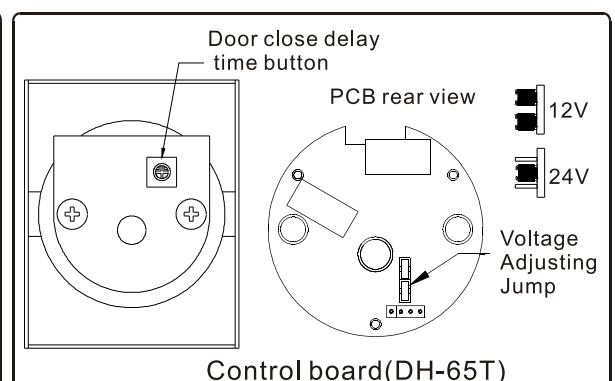
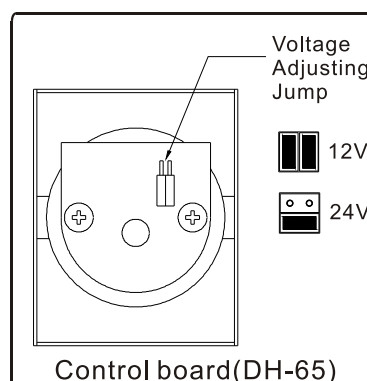
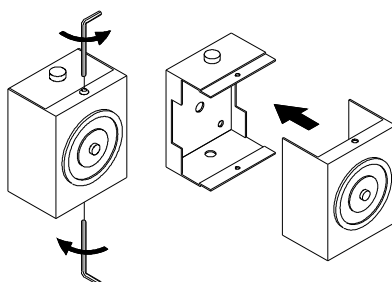

※ Wiring

Note:

Connect to fire alarm system or other 12 V or 24V power supply for all DH-60 series.

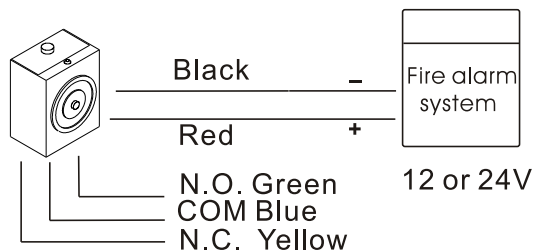

※ Connectors

Color	Model	DH-65	Color	Model	DH-65T
Red	+		Red	+	
Black	-		Black	-	
Green	N.O. Door position signal output connector				
Blue	COM Door position signal output connector				
Yellow	N.C. Door position signal output connector				

※ Delay Time Setting

Note:

It is available for DH-65T. User is able to set holding time (from 5 to 10 minutes) of electromagnetic door holder. Power is off and it releases the door after time set.

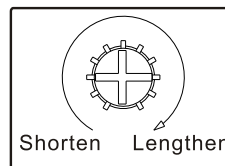

Inspection Before Installation

1. Please make sure there is enough space to mount the electromagnetic door holder when the door leaf is open wide.
2. Please make sure holding force of door closer is lower than the electromagnetic door holder (an ordinary door closer's holding force is about 20 kg).

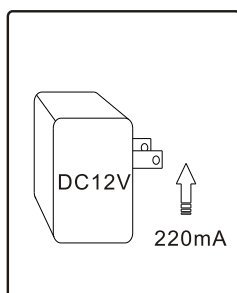

Minimum power supply
220mA@DC12V

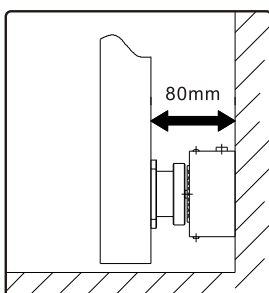

Space needed to mount
on the wall.

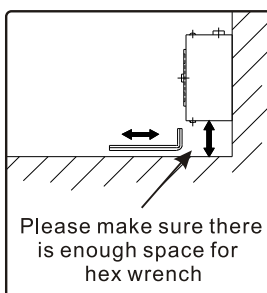

Space needed off
the ground

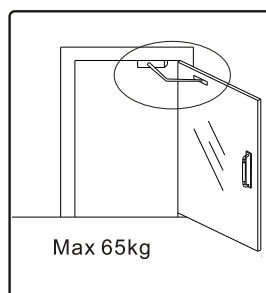

Holding force of door closer
shall be lower than
electromagnetic door holder's.

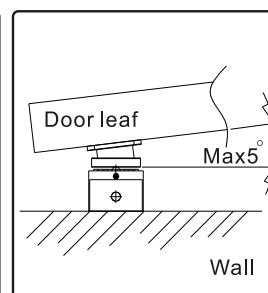

5° tilt is allowed for armature
. Please check its position
before mounting.

Installations:

☞ Step1: Please make sure its mounting position.

Please choose its mounting position, and adjust its line out position.

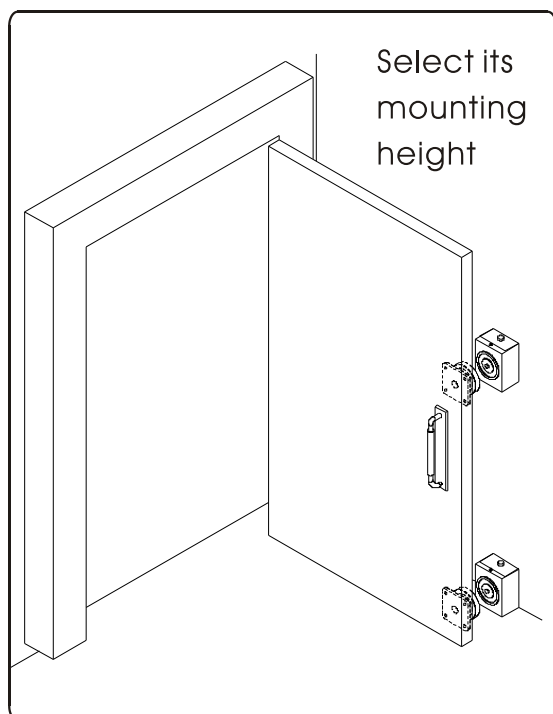

Select its
mounting
height

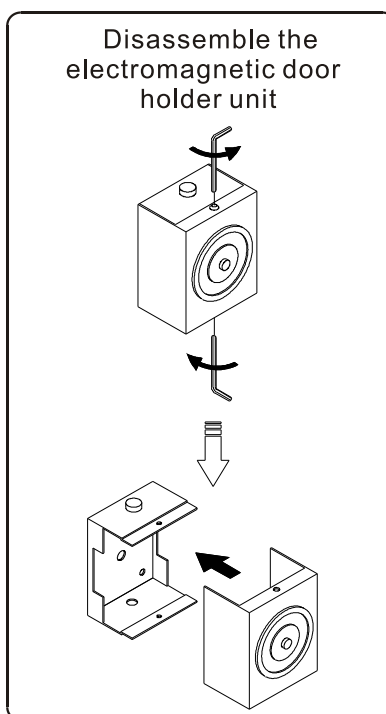

Disassemble the
electromagnetic door
holder unit

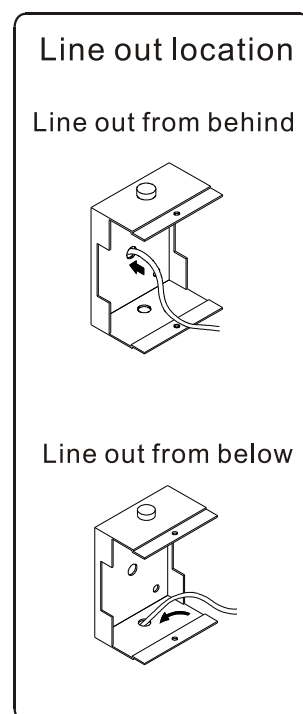

Line out location

Line out from behind

Line out from below

Step2: Voltage adjustment.

Please follow P1 to adjust the Voltage(default value as 12V DC)

DH-65T

Please disassemble its PCB to adjust the voltage(please refer to the right diagram).

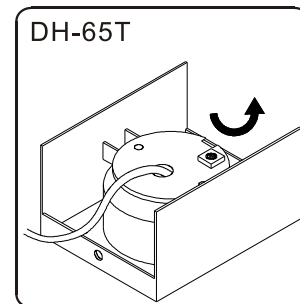
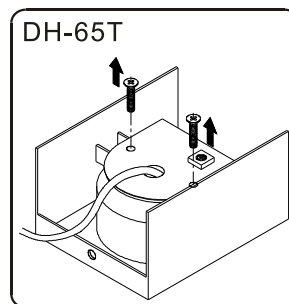

Step3: Mount the electromagnetic door holder.

Drill four holes (6.5mm)and insert plastic plug. Mount the back cover by tightening all four screws , then lock body. Please refer to P2's wiring diagram to connect all wires.

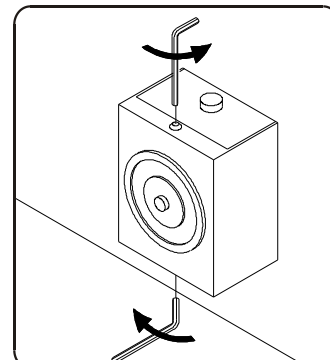
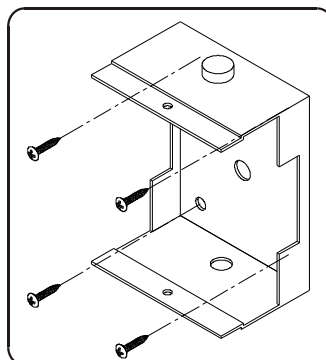
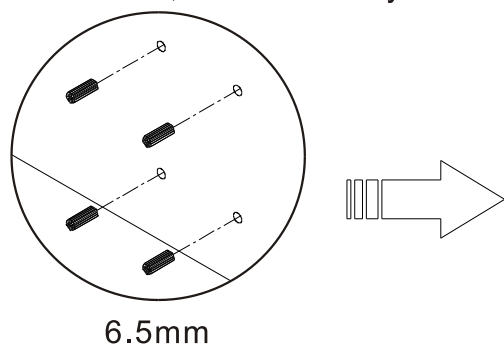

Step4: Mount the armature.

Mount the armature at the suitable position and tighten it with four screws on the door leaf.

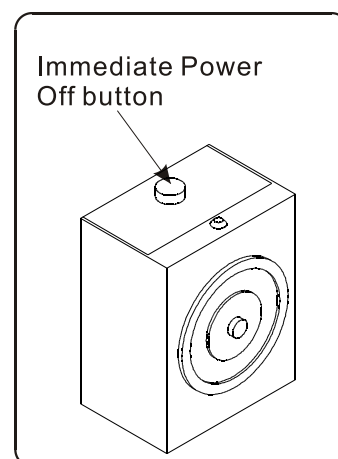
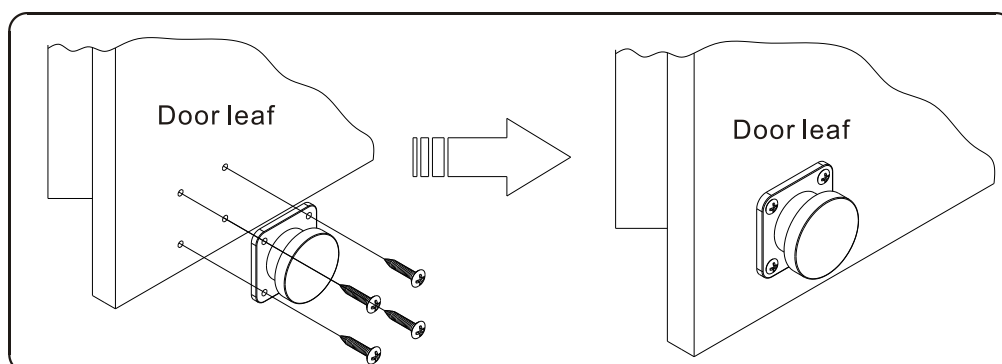

Step5: Testing.

Turn on the power to check if the electromagnetic door holder is functioning well. Press the Immediate Power Off button to check if it releases the door leaf.

Troubleshooting	
The electromagnetic door holder is unable to hold the armature firmly.	
<ul style="list-style-type: none"> ● Check power supply or current. ● Check if holding force of the door closer is higher than the electromagnetic door holder(holding force of the door closer shall not be higher than 65kg). ● Check if the surface area of the armature is well covered and attached with the surface area of electromagnetic door closer to achieve maximum holding. ● Both surface areas of the armature and electromagnetic door holder shall be free of dust or dirt in order to achieve maximum holding. ● Adjust both positions of the armature and electromagnetic door holder or re-mount them again to make sure both positions are fitted well. 	
Maintenance of the electromagnetic door holder.	
<ul style="list-style-type: none"> ● Please keep both surface areas of the armature and the electromagnetic door holder free from dust and dirt in order to achieve maximum holding. ● Due to some environmental problems(such as mounted at the seaside)may cause the rust of metal. Apply some lubricant oil(WD-40)on both surface areas of the armature and the electromagnetic door holder to prevent them from rust. 	